

0 LANDSCAPE MASTERPLAN - EXISTING FUNCTIONS AND CONDITIONS

01. INTERPRETATION NODE

02. STABLE REED AND SEDGE FORESHORE

03. DENSE CASUARINA FORESHORE PLANTING

04. INTERPRETATION NODE

05. CASUARINA GLAUCA GROVES IN DEGRADED GRASSLAND

06. SAILING CLUB ACCESS VIA DUAL USE PATH

07. EXISTING DUAL USE PATH

08. SCATTERED TREES IN POOR QUALITY OPEN GRASSLAND

09. VEHICLE, SERVICE AND SAILING CLUB ACCESS

10. INFORMAL SAILING CLUB ACCESS

11. PINE LOG BARRIER

12. FORESHORE PROTECTION BARRIERS

13. DUAL USE PATH

14. EROSION FROM BUBBLE UP ON BEACH

15. STABLE REED AND SEDGE FORESHORE
16. WATERCORP MAIN DRAIN OUTLET

17. PEDESTRIAN ACCESS

18. UNIVERSAL ACCESS PAVEMENT

19. PEDESTRIAN ACCESS

20. LARGE TREES SET WITHIN POOR QUALITY GRASSLAND

21. STABLE REED AND SEDGE FORESHORE

22. UNIVERSAL ACCESS PAVEMENT

23. PEDESTRIAN ACCESS

24. FORMALISED PARRALLEL EMBAYMENT PARKING

25. BOLLARD VEHICLE BARRIERS

26. FORESHORE PROTECTION BARRIERS

27. WATERCORP MAIN DRAIN

28.INTERPRETATION NODE
- OFF-LEAD DOG EXERCISE AREA



SHELLEY BEACH PARK - EXISTING FUNCTIONS AND CONDITIONS

CITY OF CANNING
DECEMBER 2019

JOB NO. 1904101
1:1250 @ A2

C1.101
0 25 50 75 100m
REV D

COPYRIGHT THIS DOCUMENT IS AND
SHALL REMAIN THE PROPERTY OF
PLAN E

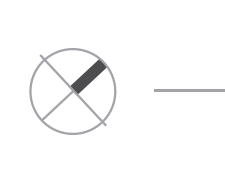

LANDSCAPE ARCHITECTS
414 ROKEBY RD SUBIACO WA 6008
T: (08) 9388 9566 E: mail@plane.com.au

0 LANDSCAPE IMAGERY - EXISTING FUNCTIONS AND CONDITIONS



POSITIVE FEATURES

SITE ISSUES

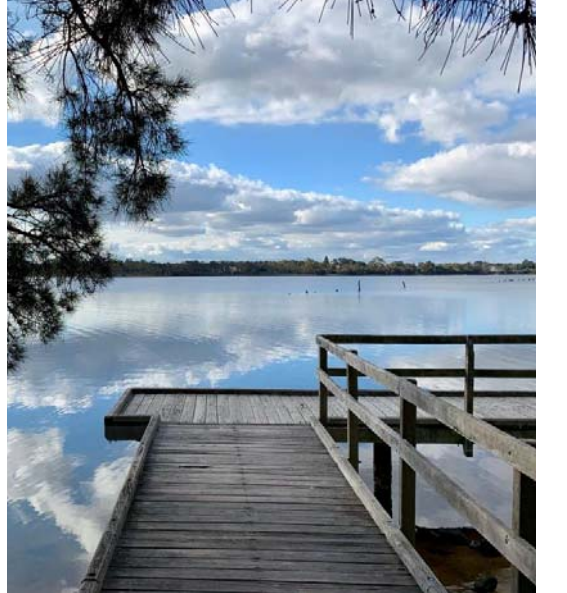

SHELLEY BEACH PARK - LANDSCAPE IMAGERY - EXISTING FUNCTIONS AND CONDITIONS

CITY OF CANNING
DECEMBER 2019

JOB NO. 1904101

REV C

COPYRIGHT THIS DOCUMENT IS AND
SHALL REMAIN THE PROPERTY OF
PLAN E

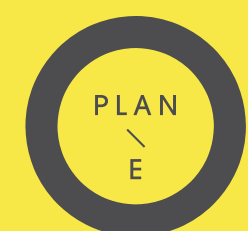

LANDSCAPE ARCHITECTS

414 ROKEBY RD SUBIACO WA 6008
T: (08) 9388 9566 E: mail@plane.com.au

1 LANDSCAPE MASTERPLAN - OPTION 1 - RETAIN & ENHANCE EXISTING FACILITIES

01. RETAIN EXISTING JETTY

02. ENHANCE STABLE REED AND SEDGE FORESHORE

03. REMOVE GRASS AND REPLACE WITH GARDEN BEDS CONTAINING NATIVE GROUNDCOVERS TO ALLOW VIEWS ACROSS SITE

04. UPGRADE IRRIGATION INFRASTRUCTURE AND AMELIORATE DEGRADED TURF

05. ENHANCE OPEN GRASSLAND WITH PLANTING OF GROVES OF TREES TO DEFINE SPACES, PROVIDE ADDITIONAL SHADE AND HABITAT VALUE WHILE ALLOWING VIEWS ACROSS SITE

06. REMOVE EXISTING FOOTPATH LINK, AND SELECTIVELY REMOVE EXISTING CASUARINA GLAUCA COMBINED WITH UNDER-PRUNING OF REMAINING TREES TO IMPROVE FUNCTION OF SPACE AND VISIBILITY FOR PARK USERS

07. SELECTIVELY REMOVE CASUARINA GLAUCA AND REPLACE WITH LOCAL INDIGENOUS SPECIES FOR HABITAT CREATION, REMOVE LAWN BETWEEN PATH AND EXISTING FORESHORE VEGETATION AND REVEGETATE WITH FORESHORE PLANTING TO ENHANCE HABITAT BUFFER AND NUTRIENT MANAGEMENT

08. RETAIN SAILING CLUB CURRENT FUNCTIONS AND ENHANCE BUILDING AND SURROUNDINGS

09. ENHANCED RIVERSIDE PLANTING AS ENVIRONMENTAL BUFFER, REMOVE LAWN BETWEEN PATH AND EXISTING FORESHORE VEGETATION AND REVEGETATE WITH FORESHORE PLANTING TO ENHANCE HABITAT BUFFER AND NUTRIENT MANAGEMENT

10. RETAIN EXISTING SAILING CLUB ACCESS VIA NEW FOOTPATH

11. RETAIN AND ENHANCE EXISTING PUBLIC CANOE ACCESS BY CREATING PAVED ACCESS POINTS ONTO BEACH

12. NEW JUNIOR FOOTBALL POSTS FOR INFORMAL ACTIVE PLAY

13. NEW FOOTPATH LINK

14. CONSIDER REMOVAL OF PINE LOG BARRIER TO IMPROVE FUNCTION OF OPEN GRASSLAND

15. FORMALISE SAILING CLUB VEHICULAR ACCESS VIA NEW SHARED USE PATH

16. INTRODUCE TREE PLANTING TO PARK PERIMETER TO ENHANCE STREETSCAPE AND PROVIDE DEFINITION TO MULTI-USE LAWN AREA

17. RETAIN EXISTING VEHICLE, SERVICE AND SAILING CLUB ACCESS

18. OFF-LEAD DOG EXERCISE AREA IS RETAINED

19. REMOVE EXISTING SHARED USE PATH AND REPLACE WITH COLOURED CONCRETE FOOTPATH. REFINE ALIGNMENT WHERE NECESSARY

20. MODIFY AND RELOCATE BUBBLE UP PIT WITHIN SEDGE PLANTING TO PREVENT OVERLAND FLOW ACROSS LAWN AND BEACH EROSION

21. A SERIES OF OUTDOOR EXERCISE STATIONS ARE PROPOSED ALONG FOOTPATH TO PROVIDE AN EXERCISE CIRCUIT

22. PROPOSED NEW SHARED USE PATH

23. ENHANCED DISTRICT MULTI GENERATIONAL PLAY SPACE WITH IMPROVED ACCESSIBILITY AND INCLUSIVITY

24. RAISED PLATEAU FOR TRAFFIC CALMING AND DEFINING ENTRY TO PRECINCT

25. MONITOR AND ENHANCE REED AND SEDGE FORESHORE AS REQUIRED

26. RETAIN EXISTING INFORMAL EVENT PARKING

27. MAINTAIN AND ENHANCE DUAL USE PATH SERVICE VEHICLE ACCESS

28. REMOVE EXISTING DRAIN AND CREATE LIVING STREAM WITH 2 WIDE TRAFFICABLE FOOTBRIDGE CROSSINGS

29. RETAIN EXISTING JETTY

30. RETAIN AND REFURBISH EXISTING TOILET AND STORAGE FACILITIES

31. REMOVE EXISTING BBQ AND PICNIC FACILITIES AND REPLACE WITH NEW

32. RETAIN EXISTING SAND BEACH AND RETAINING WALL

33. RELOCATE EXISTING SHARED USE PATH TOWARDS RIVERTON DVE TO CREATE OPEN GRASSED AREA FOR PASSIVE RECREATION, EVENTS SPACE AND FESTIVAL SITE

34. RAISED PLATEAU TO DEFINE PEDESTRIAN CROSSING POINT

35. NEW PEDESTRIAN ENTRY POINT AND POTENTIAL FOR PUBLIC ART

36. ENHANCE EXISTING PEDESTRIAN ENTRY POINT

37. PROPOSED PICNIC NODES WITH SHELTERS, BARBEQUES AND SEATING

38. REPLACE EXISTING ASPHALT DUAL USE PATH WITH CONCRETE SHARED USE PATH

39. EXISTING LARGE EUCALYPTS PROVIDE IMPRESSIVE ENTRY TO PARK

40. ENHANCE EXISTING PEDESTRIAN ENTRY WITH SIGNAGE OR PUBLIC ART

41. RETAIN EXISTING MAIN DRAIN

42. NEW RIPERIAN PLANTING TO ENHANCE ENVIRONMENTAL ZONE BUFFER

43. RETAIN INTERPRETATION NODE

44. OPEN TREE GRASSLAND

45. REPLACE 20 EXISTING PARALLEL CAR BAYS WITH 46 NO. MAX 90 DEGREE CAR BAYS (26 MAX. ADDITIONAL CAR BAYS)

46. RETAIN EXISTING PARALLEL CAR BAYS

47. POTENTIAL ROAD MODIFICATIONS

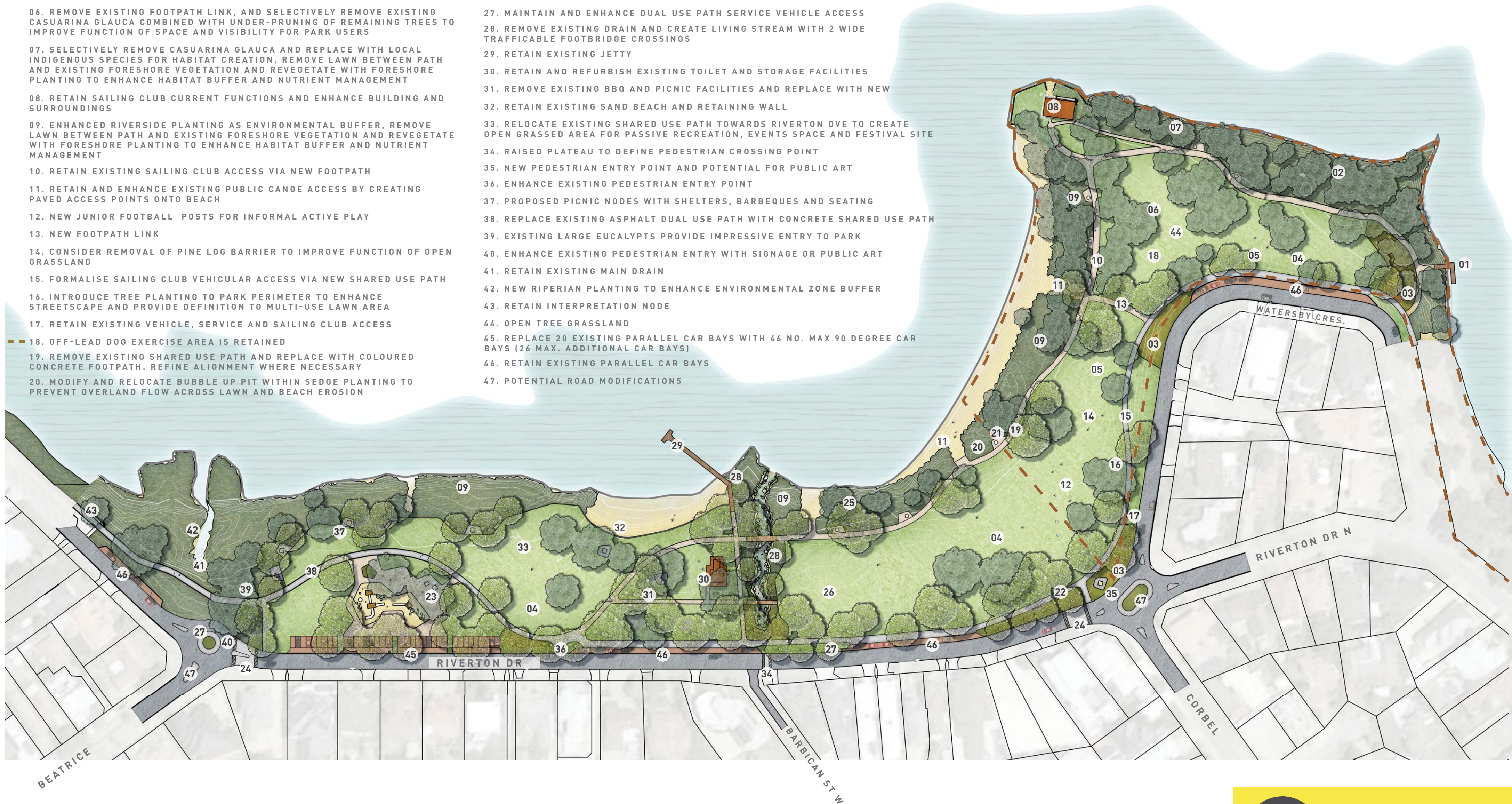

SHELLEY BEACH PARK - LANDSCAPE MASTERPLAN - OPTION 1 - RETAIN & ENHANCE EXISTING FACILITIES

CITY OF CANNING
DECEMBER 2019

JOB NO. 1904101
1:1250 @ A2

C1.102
0 25 50 75 100m
REV E

COPYRIGHT THIS DOCUMENT IS AND
SHALL REMAIN THE PROPERTY OF
PLAN E



LANDSCAPE ARCHITECTS
414 ROKEBY RD SUBIACO WA 6008
T: (08) 9388 9566 E: mail@plane.com.au

1 LANDSCAPE IMAGERY - OPTION 1 - RETAIN & ENHANCE EXISTING FACILITIES

FORESHORE



PLAYGROUND



PICNIC & BARBECUE AREAS

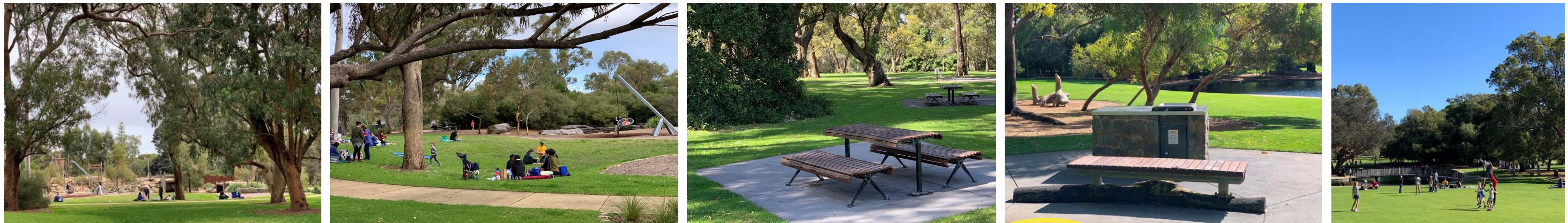

PUBLIC ART



SHELLEY BEACH PARK - LANDSCAPE IMAGERY - OPTION 1 - RETAIN & ENHANCE EXISTING FACILITIES

CITY OF CANNING
DECEMBER 2019

JOB NO. 1904101

REV C

COPYRIGHT THIS DOCUMENT IS AND
SHALL REMAIN THE PROPERTY OF
PLAN E

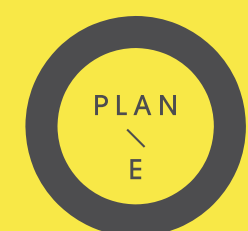

LANDSCAPE ARCHITECTS
414 ROKEBY RD SUBIACO WA 6008
T: (08) 9388 9566 E: mail@plane.com.au

2 LANDSCAPE MASTERPLAN - OPTION 2 - SERVICED FOOD & COFFEE VANS

01. RETAIN EXISTING JETTY

02. ENHANCE STABLE REED AND SEDGE FORESHORE

03. REMOVE GRASS AND REPLACE WITH GARDENBEDS CONTAINING NATIVE GROUNDCOVERS TO ALLOW VIEWS ACROSS SITE

04. UPGRADE IRRIGATION INFRASTRUCTURE AND AMELIORATE DEGRADED TURF

05. ENHANCE OPEN GRASSLAND WITH PLANTING OF GROVES OF TREES TO DEFINE SPACES, PROVIDE ADDITIONAL SHADE AND HABITAT VALUE WHILE ALLOWING VIEWS ACROSS SITE

06. REMOVE EXISTING FOOTPATH LINK, AND SELECTIVELY REMOVE EXISTING CASUARINA GLAUCA COMBINED WITH UNDER-PRUNING OF REMAINING TREES TO IMPROVE FUNCTION OF SPACE AND VISIBILITY FOR PARK USERS

07. SELECTIVELY REMOVE CASUARINA GLAUCA AND REPLACE WITH LOCAL INDIGENOUS SPECIES FOR HABITAT CREATION, REMOVE LAWN BETWEEN PATH AND EXISTING FORESHORE VEGETATION AND REVEGETATE WITH FORESHORE PLANTING TO ENHANCE HABITAT BUFFER AND NUTRIENT MANAGEMENT

08. RETAIN SAILING CLUB CURRENT FUNCTIONS AND ENHANCE BUILDING AND SURROUNDINGS

09. ENHANCED RIVERSIDE PLANTING AS ENVIRONMENTAL BUFFER, REMOVE LAWN BETWEEN PATH AND EXISTING FORESHORE VEGETATION AND REVEGETATE WITH FORESHORE PLANTING TO ENHANCE HABITAT BUFFER AND NUTRIENT MANAGEMENT

10. RETAIN EXISTING SAILING CLUB ACCESS VIA NEW FOOTPATH

11. RETAIN AND ENHANCE EXISTING PUBLIC CANOE ACCESS BY CREATING PAVED ACCESS POINTS ONTO BEACH

12. NEW JUNIOR FOOTBALL POSTS FOR INFORMAL ACTIVE PLAY

13. NEW FOOTPATH LINK

14. CONSIDER REMOVAL OF PINE LOG BARRIER TO IMPROVE FUNCTION OF OPEN GRASSLAND

15. FORMALISE SAILING CLUB VEHICULAR ACCESS VIA NEW SHARED USE PATH

16. INTRODUCE TREE PLANTING TO PARK PERIMETER TO ENHANCE STREETSCAPE AND PROVIDE DEFINITION TO MULTI-USE LAWN AREA

17. RETAIN EXISTING VEHICLE, SERVICE AND SAILING CLUB ACCESS

18. NEW SERVICE VEHICLE ACCESS FOR FOOD/COFFEE VANS

19. REMOVE EXISTING SHARED USE PATH AND REPLACE WITH COLOURED CONCRETE FOOTPATH. REFINE ALIGNMENT WHERE NECESSARY

20. MODIFY AND RELOCATE BUBBLE UP PIT WITHIN SEDGE PLANTING TO PREVENT OVERLAND FLOW ACROSS LAWN AND BEACH EROSION

21. A SERIES OF OUTDOOR EXERCISE STATIONS ARE PROPOSED ALONG FOOTPATH TO PROVIDE AN EXERCISE CIRCUIT

22. PROPOSED NEW SHARED USE PATH

23. ENHANCED DISTRICT MULTI GENERATIONAL PLAY SPACE WITH IMPROVED ACCESSIBILITY AND INCLUSIVITY

24. RAISED PLATEAU FOR TRAFFIC CALMING AND DEFINING ENTRY TO PRECINCT

25. MONITOR AND ENHANCE REED AND SEDGE FORESHORE AS REQUIRED

26. RETAIN EXISTING INFORMAL EVENT PARKING

27. REMOVE SERVICE VEHICLE ACCESS, AND REPLACE WITH NEW SERVICE VEHICLE ACCESS FOR FOOD/COFFEE VANS

28. REMOVE EXISTING DRAIN AND CREATE LIVING STREAM WITH 2 WIDE TRAFFICABLE FOOTBRIDGE CROSSINGS

29. RETAIN EXISTING JETTY

30. RETAIN AND REFURBISH EXISTING TOILET AND STORAGE FACILITIES

31. REMOVE EXISTING BBQ AND PICNIC FACILITIES AND REPLACE WITH NEW

32. REMOVE EXISTING BEACH EDGE WALL AND CREATE NEW BEACH EDGE COMPRISING LARGE DECKS AND PAVED PROMENADE WITH CUSTOM TIMBER LOUNGING FURNITURE AND TREE PLANTING

33. RELOCATE EXISTING SHARED USE PATH TOWARDS RIVERTON DVE TO CREATE OPEN GRASSED AREA FOR PASSIVE RECREATION, EVENTS SPACE AND FESTIVAL SITE

34. RAISED PLATEAU TO DEFINE PEDESTRIAN CROSSING POINT

35. NEW PEDESTRIAN ENTRY POINT AND POTENTIAL FOR PUBLIC ART

36. ENHANCE EXISTING PEDESTRIAN ENTRY POINT

37. PROPOSED PICNIC NODES WITH SHELTERS, BARBEQUES AND SEATING

38. REPLACE EXISTING ASPHALT DUAL USE PATH WITH CONCRETE SHARED USE PATH

39. EXISTING LARGE EUCALYPTS PROVIDE IMPRESSIVE ENTRY TO PARK

40. ENHANCE EXISTING PEDESTRIAN ENTRY WITH SIGNAGE OR PUBLIC ART

41. RETAIN EXISTING MAIN DRAIN

42. NEW RIPERIAN PLANTING TO ENHANCE ENVIRONMENTAL ZONE BUFFER

43. RETAIN INTERPRETATION NODE

44. OFF-LEAD DOG EXERCISE AREA IS RETAINED

45. REPLACE 20 EXISTING PARALLEL CAR BAYS WITH 46 NO. MAX 90 DEGREE CAR BAYS (26 ADDITIONAL CAR BAYS, INCLUDING ACROD)

46. RETAIN EXISTING PARALLEL CAR BAYS

47. POTENTIAL ROAD MODIFICATIONS

48. ZONE FOR SERVICED FOOD/COFFEE VANS



SHELLEY BEACH PARK - LANDSCAPE MASTERPLAN - OPTION 2 - SERVICED FOOD & COFFEE VANS

CITY OF CANNING
DECEMBER 2019

JOB NO. 1904101
1:1250 @ A2

C1.103
0 25 50 75 100m
REV F

COPYRIGHT THIS DOCUMENT IS AND
SHALL REMAIN THE PROPERTY OF
PLAN E

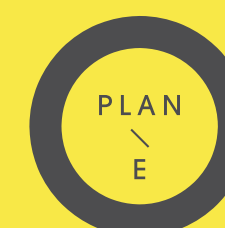

LANDSCAPE ARCHITECTS
414 ROKEBY RD SUBIACO WA 6008
T: (08) 9388 9566 E: mail@plane.com.au

2 LANDSCAPE IMAGERY - OPTION 2 - SERVICED FOOD & COFFEE VANS

FORESHORE



LIVING STREAM



PLAYGROUND



PUBLIC ART



PICNIC & BARBECUE AREAS

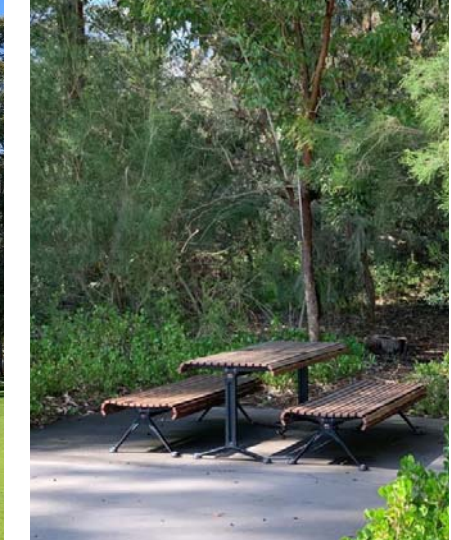

FOOD & COFFEE VANS



SHELLEY BEACH PARK - LANDSCAPE IMAGERY - OPTION 2 - SERVICED FOOD & COFFEE VANS

CITY OF CANNING
DECEMBER 2019

JOB NO. 1904101

REV C

COPYRIGHT THIS DOCUMENT IS AND
SHALL REMAIN THE PROPERTY OF
PLAN E



LANDSCAPE ARCHITECTS
414 ROKEBY RD SUBIACO WA 6008
T: (08) 9388 9566 E: mail@plane.com.au

2 LANDSCAPE MASTERPLAN - OPTION 2 - SERVICED FOOD & COFFEE VANS

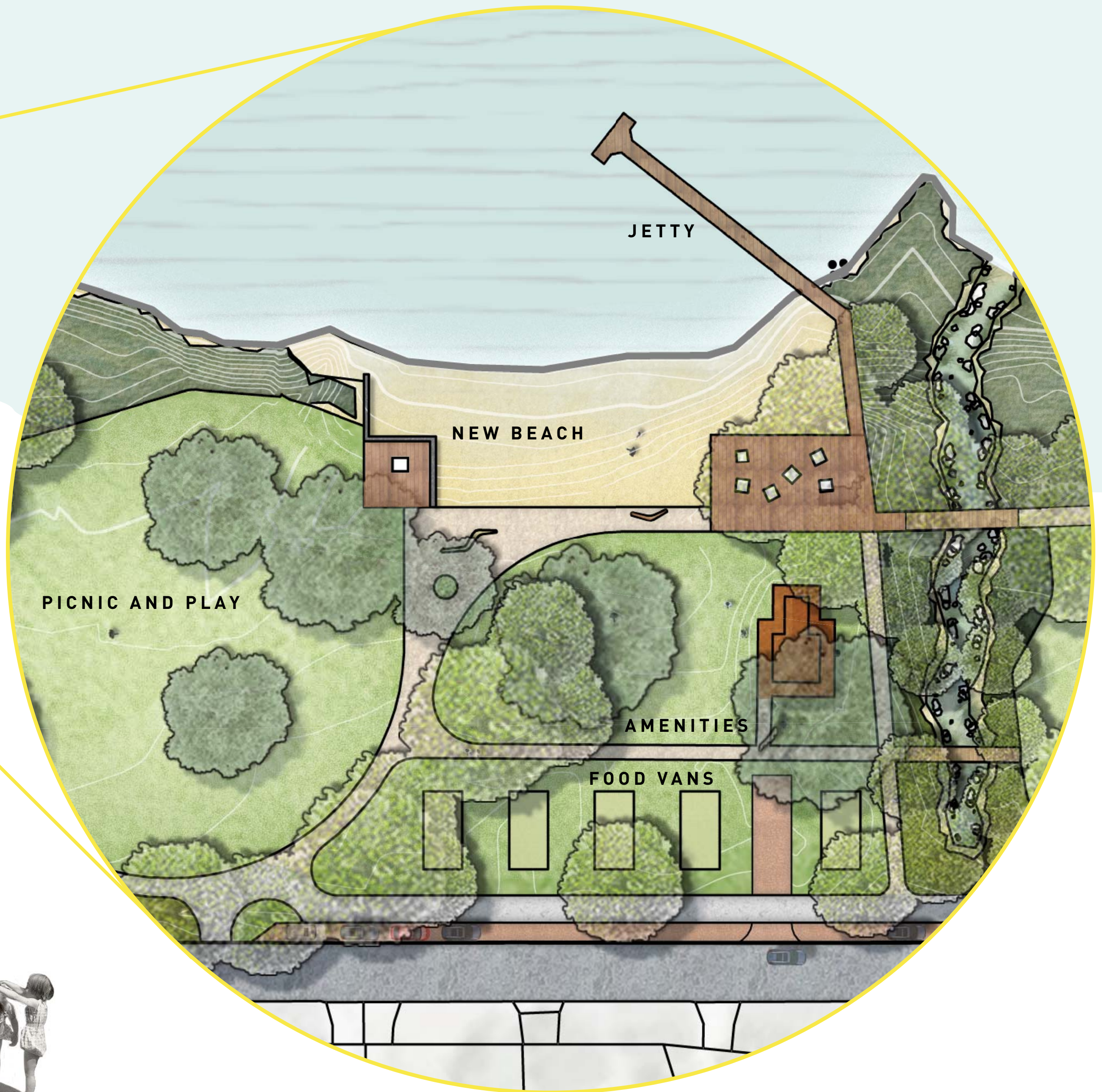

SHELLEY BEACH PARK - LANDSCAPE MASTERPLAN - OPTION 2 - SERVICED FOOD & COFFEE VANS

CITY OF CANNING
DECEMBER 2019

JOB NO. 1904101

REV E

COPYRIGHT THIS DOCUMENT IS AND
SHALL REMAIN THE PROPERTY OF
PLAN E

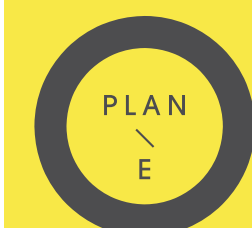

LANDSCAPE ARCHITECTS
414 ROKEBY RD SUBIACO WA 6008
T: (08) 9388 9566 E: mail@plane.com.au

3 LANDSCAPE MASTERPLAN - OPTION 3 - 100 SEAT CAFE

01. RETAIN EXISTING JETTY

02. ENHANCE STABLE REED AND SEDGE FORESHORE

03. REMOVE GRASS AND REPLACE WITH GARDEN BEDS CONTAINING NATIVE GROUNDCOVERS TO ALLOW VIEWS ACROSS SITE

04. UPGRADE IRRIGATION INFRASTRUCTURE AND AMELIORATE DEGRADED TURF

05. ENHANCE OPEN GRASSLAND WITH PLANTING OF GROVES OF TREES TO DEFINE SPACES, PROVIDE ADDITIONAL SHADE AND HABITAT VALUE WHILE ALLOWING VIEWS ACROSS SITE

06. REMOVE EXISTING FOOTPATH LINK, AND SELECTIVELY REMOVE EXISTING CASUARINA GLAUCA COMBINED WITH UNDER-PRUNING OF REMAINING TREES TO IMPROVE FUNCTION OF SPACE AND VISIBILITY FOR PARK USERS

07. SELECTIVELY REMOVE CASUARINA GLAUCA AND REPLACE WITH LOCAL INDIGENOUS SPECIES FOR HABITAT CREATION, REMOVE LAWN BETWEEN PATH AND EXISTING FORESHORE VEGETATION AND REVEGETATE WITH FORESHORE PLANTING TO ENHANCE HABITAT BUFFER AND NUTRIENT MANAGEMENT

08. RETAIN SAILING CLUB CURRENT FUNCTIONS AND ENHANCE BUILDING AND SURROUNDINGS

09. ENHANCED RIVERSIDE PLANTING AS ENVIRONMENTAL BUFFER, REMOVE LAWN BETWEEN PATH AND EXISTING FORESHORE VEGETATION AND REVEGETATE WITH FORESHORE PLANTING TO ENHANCE HABITAT BUFFER AND NUTRIENT MANAGEMENT

10. RETAIN EXISTING SAILING CLUB ACCESS VIA NEW FOOTPATH

11. RETAIN AND ENHANCE EXISTING PUBLIC CANOE ACCESS BY CREATING PAVED ACCESS POINTS ONTO BEACH

12. NEW JUNIOR FOOTBALL POSTS FOR INFORMAL ACTIVE PLAY

13. NEW FOOTPATH LINK

14. CONSIDER REMOVAL OF PINE LOG BARRIER TO IMPROVE FUNCTION OF OPEN GRASSLAND

15. FORMALISE SAILING CLUB VEHICULAR ACCESS VIA NEW SHARED USE PATH

16. INTRODUCE TREE PLANTING TO PARK PERIMETER TO ENHANCE STREETSCAPE AND PROVIDE DEFINITION TO MULTI-USE LAWN AREA

17. RETAIN EXISTING VEHICLE, SERVICE AND SAILING CLUB ACCESS

18. NEW SERVICE VEHICLE ACCESS FOR CAFE

19. REMOVE EXISTING SHARED USE PATH AND REPLACE WITH COLOURED CONCRETE FOOTPATH. REFINE ALIGNMENT WHERE NECESSARY

20. MODIFY AND RELOCATE BUBBLE UP PIT WITHIN SEDGE PLANTING TO PREVENT OVERLAND FLOW ACROSS LAWN AND BEACH EROSION

21. A SERIES OF OUTDOOR EXERCISE STATIONS ARE PROPOSED ALONG FOOTPATH TO PROVIDE AN EXERCISE CIRCUIT

22. PROPOSED NEW SHARED USE PATH

23. ENHANCED DISTRICT MULTI GENERATIONAL PLAY SPACE WITH IMPROVED ACCESSIBILITY AND INCLUSIVITY

24. RAISED PLATEAU FOR TRAFFIC CALMING AND DEFINING ENTRY TO PRECINCT

25. MONITOR AND ENHANCE REED AND SEDGE FORESHORE AS REQUIRED

26. RETAIN EXISTING INFORMAL EVENT PARKING

27. REMOVE SERVICE VEHICLE ACCESS, AND REPLACE WITH NEW SERVICE VEHICLE ACCESS FOR CAFE

28. REMOVE EXISTING DRAIN AND CREATE LIVING STREAM WITH 2 WIDE, TRAFFICABLE FOOTBRIDGE CROSSINGS

29. RETAIN EXISTING JETTY

30. PROPOSED 100 SEAT CAFE (INTERNAL AND ALFRESCO DINING)

31. REMOVE EXISTING BBQ AND PICNIC FACILITIES AND REPLACE WITH NEW

32. REMOVE EXISTING BEACH EDGE WALL AND CREATE NEW BEACH EDGE COMPRISING LARGE DECKS AND PAVED PROMENADE WITH CUSTOM TIMBER LOUNGING FURNITURE AND TREE PLANTING

33. RELOCATE EXISTING SHARED USE PATH TOWARDS RIVERTON DVE TO CREATE OPEN GRASSED AREA FOR PASSIVE RECREATION, EVENTS SPACE AND FESTIVAL SITE

34. RAISED PLATEAU TO DEFINE PEDESTRIAN CROSSING POINT

35. NEW PEDESTRIAN ENTRY POINT AND POTENTIAL FOR PUBLIC ART

36. ENHANCE EXISTING PEDESTRIAN ENTRY POINT

37. PROPOSED PICNIC NODES WITH SHELTERS, BARBECUES AND SEATING

38. REPLACE EXISTING ASPHALT DUAL USE PATH WITH CONCRETE SHARED USE PATH

39. EXISTING LARGE EUCALYPTS PROVIDE IMPRESSIVE ENTRY TO PARK

40. ENHANCE EXISTING PEDESTRIAN ENTRY WITH SIGNAGE OR PUBLIC ART

41. RETAIN EXISTING MAIN DRAIN

42. NEW RIPERIAN PLANTING TO ENHANCE ENVIRONMENTAL ZONE BUFFER

43. RETAIN INTERPRETATION NODE

44. OFF-LEAD DOG EXERCISE AREA IS RETAINED

45. REPLACE 33 EXISTING PARALLEL CAR BAYS WITH 76 NO. 90 DEGREE CAR BAYS AND INSTALL 40 NEW 90 DEGREE BAYS (83 ADDITIONAL CAR BAYS, INCLUDING ACROD)

46. RETAIN EXISTING PARALLEL CAR BAYS

47. POTENTIAL ROAD MODIFICATIONS

48. POTENTIAL 13 ADDITIONAL CAR BAYS (BY CONVERTING 10 EXISTING PARRALEL BAYS INTO 23 90 DEGREE BAYS)



SHELLEY BEACH PARK - LANDSCAPE MASTERPLAN - OPTION 3 - 100 SEAT CAFE

CITY OF CANNING
DECEMBER 2019

JOB NO. 1904101
1:1250 @ A2

C1.104
0 25 50 75 100m
REV F

COPYRIGHT THIS DOCUMENT IS AND
SHALL REMAIN THE PROPERTY OF
PLAN E

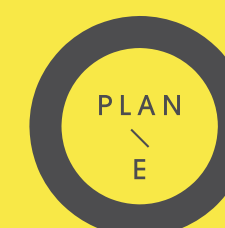

LANDSCAPE ARCHITECTS
414 ROKEBY RD SUBIACO WA 6008
T: (08) 9388 9566 E: mail@plane.com.au

3 LANDSCAPE IMAGERY - OPTION 3 - 100 SEAT CAFE

FORESHORE



PICNIC & BARBECUE AREAS



PLAYGROUND



BEACH

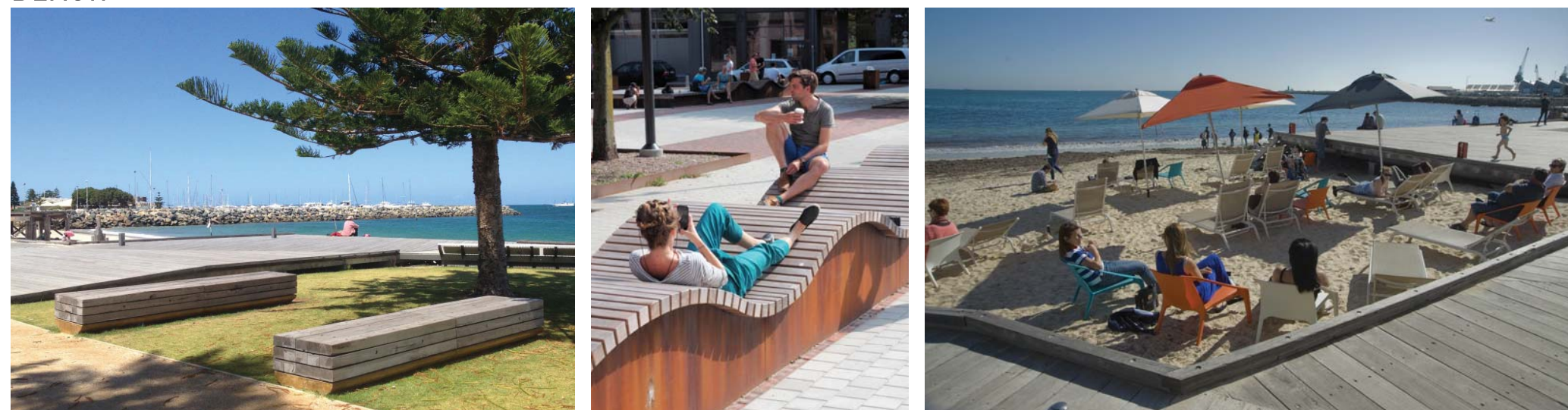

CAFE



PUBLIC ART



LIVING STREAM



SHELLEY BEACH PARK - LANDSCAPE IMAGERY - OPTION 3 - 100 SEAT CAFE

CITY OF CANNING
DECEMBER 2019

JOB NO. 1904101

REV C

COPYRIGHT THIS DOCUMENT IS AND
SHALL REMAIN THE PROPERTY OF
PLAN E



LANDSCAPE ARCHITECTS

414 ROKEBY RD SUBIACO WA 6008
T: (08) 9388 9566 E: mail@plane.com.au

3 LANDSCAPE MASTERPLAN - OPTION 3 - 100 SEAT CAFE

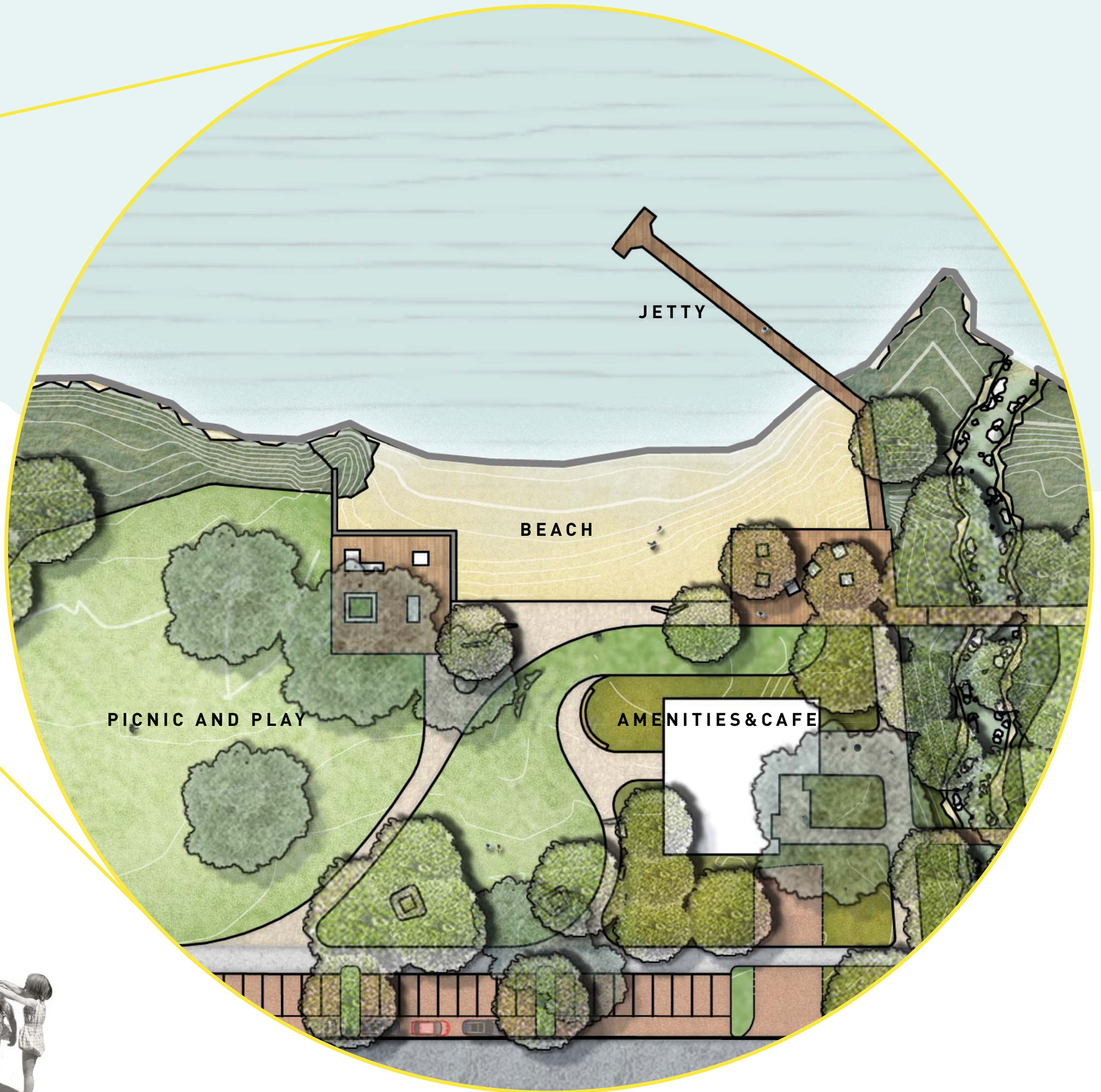
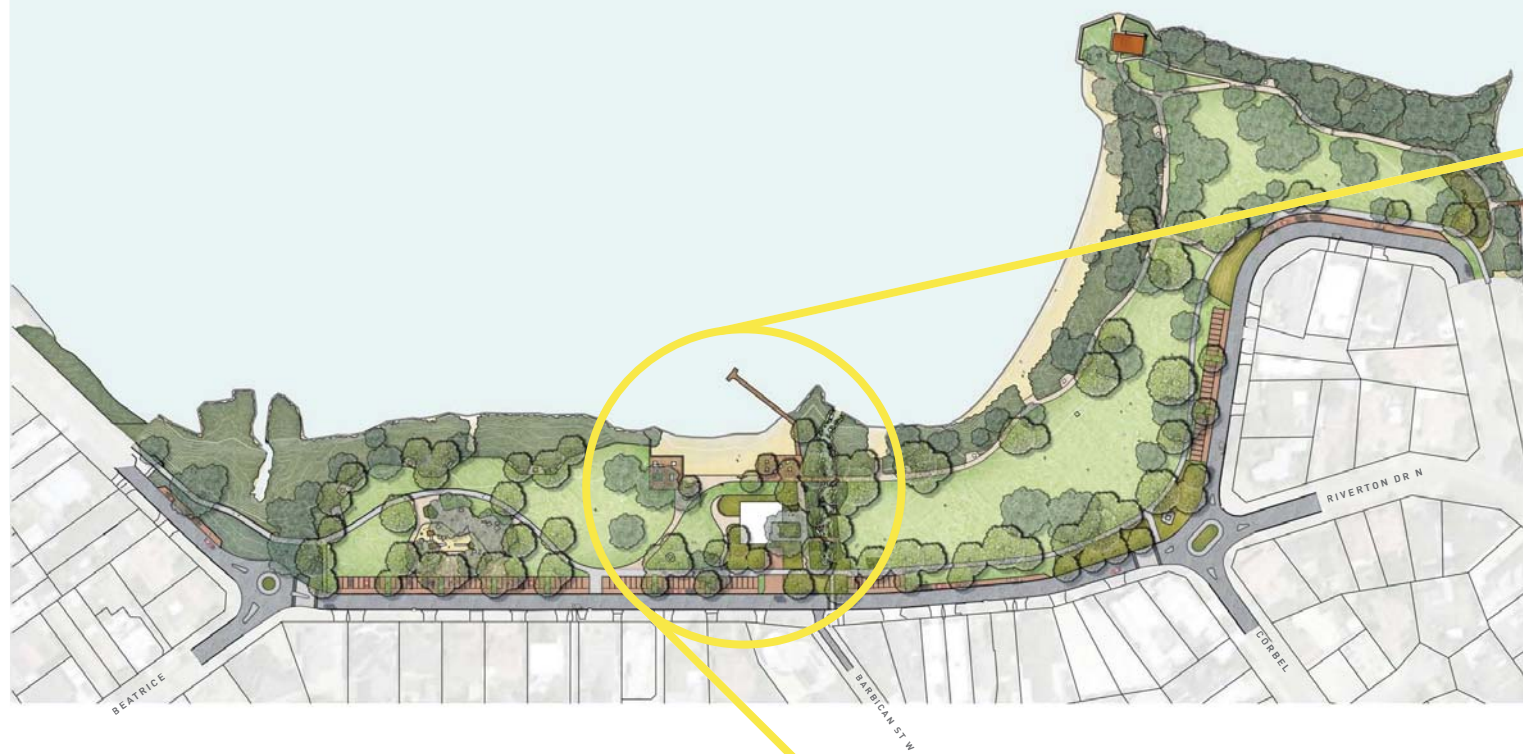

SHELLEY BEACH PARK - LANDSCAPE MASTERPLAN - OPTION 3 - 100 SEAT CAFE

CITY OF CANNING
DECEMBER 2019

JOB NO. 1904101

REV D

COPYRIGHT THIS DOCUMENT IS AND
SHALL REMAIN THE PROPERTY OF
PLAN E



LANDSCAPE ARCHITECTS
414 ROKEBY RD SUBIACO WA 6008
T: (08) 9388 9566 E: mail@plane.com.au

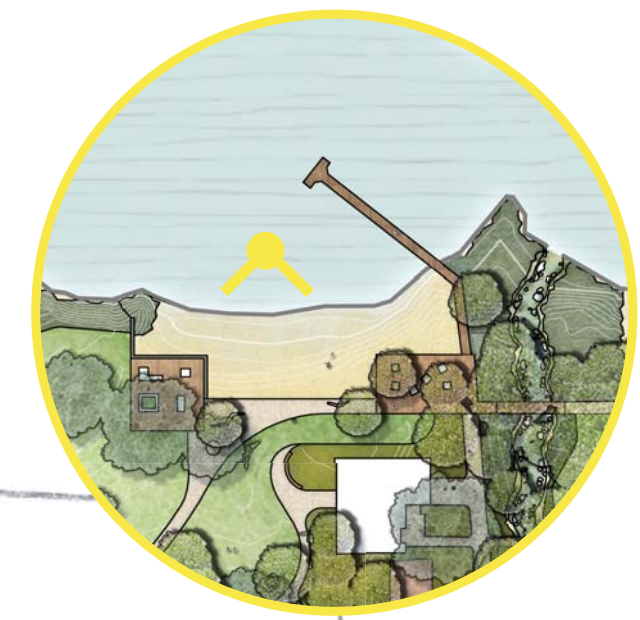

SHELLEY BEACH PARK - LANDSCAPE PERSPECTIVE - BEACH SIDE CAFE

CITY OF CANNING
DECEMBER 2019

JOB NO. 1904101

REV A

COPYRIGHT THIS DOCUMENT IS AND
SHALL REMAIN THE PROPERTY OF
PLAN E

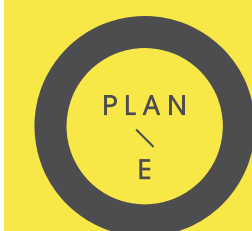

LANDSCAPE ARCHITECTS

414 ROKEBY RD SUBIACO WA 6008
T: (08) 9388 9566 E: mail@plane.com.au

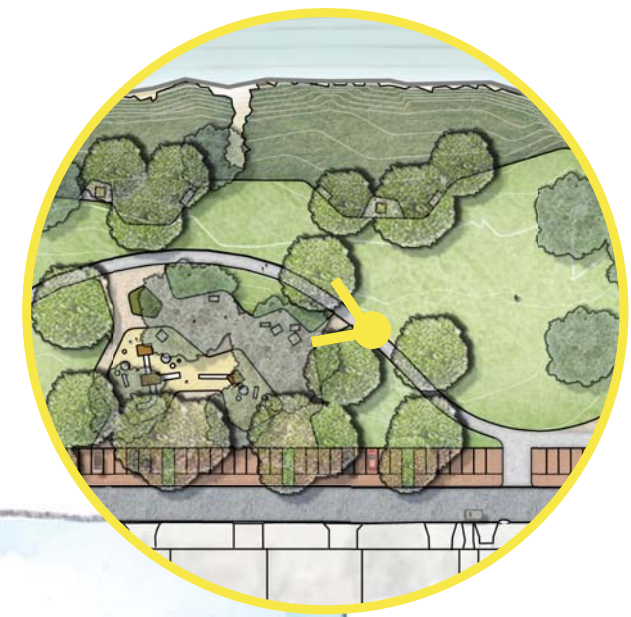

SHELLEY BEACH PARK - - LANDSCAPE PERSPECTIVE - PLAYGROUND & PASSIVE RECREATION

CITY OF CANNING
DECEMBER 2019

JOB NO. 1904101

REV A

COPYRIGHT THIS DOCUMENT IS AND
SHALL REMAIN THE PROPERTY OF
PLAN E

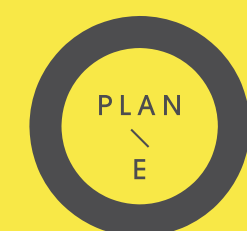

LANDSCAPE ARCHITECTS
414 ROKEBY RD SUBIACO WA 6008
T: (08) 9388 9566 E: mail@plane.com.au

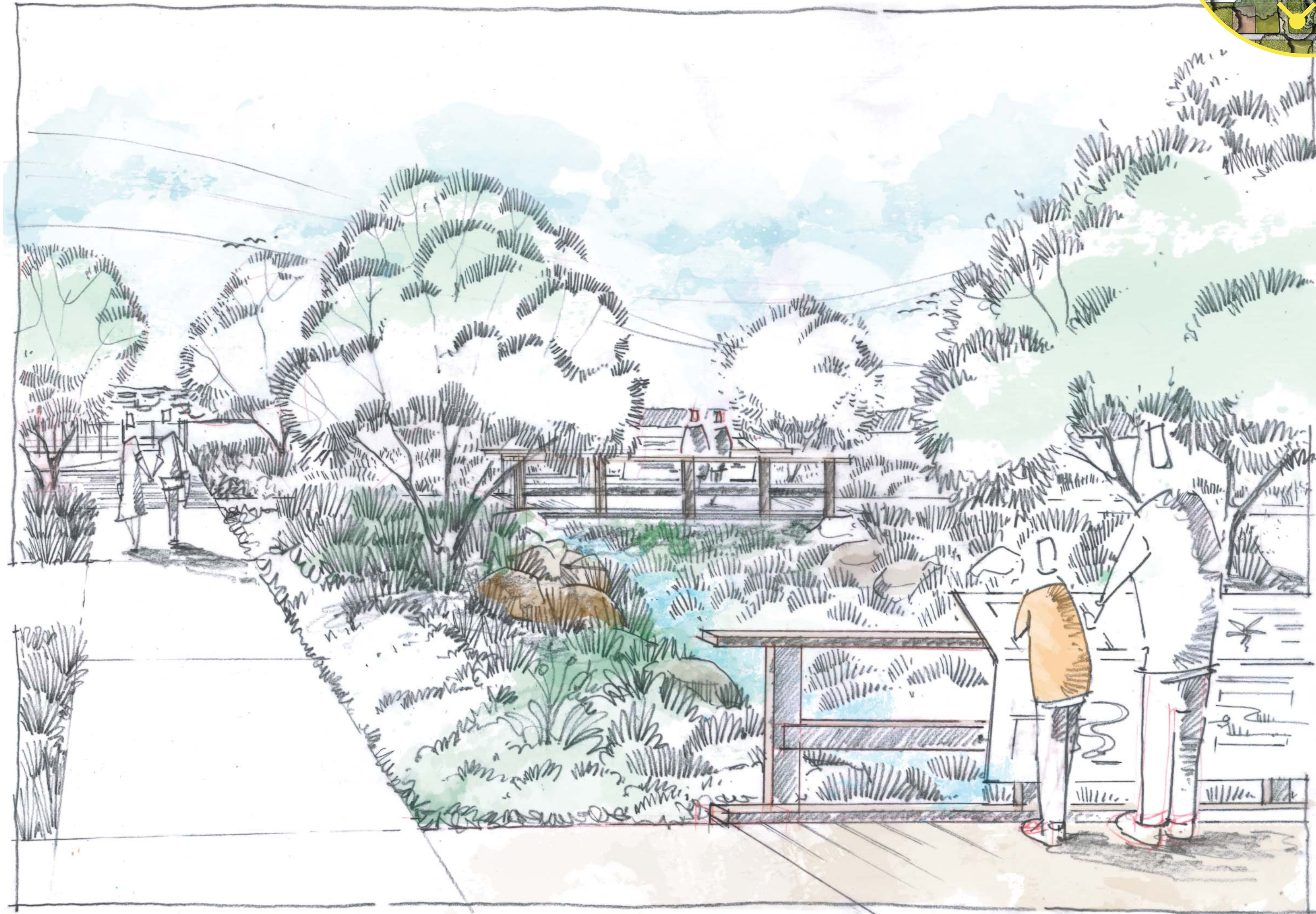

SHELLEY BEACH PARK - LANDSCAPE PERSPECTIVE - LIVING STREAM

CITY OF CANNING
DECEMBER 2019

JOB NO. 1904101

REV A

COPYRIGHT THIS DOCUMENT IS AND
SHALL REMAIN THE PROPERTY OF
PLAN E

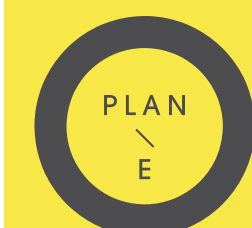

LANDSCAPE ARCHITECTS

414 ROKEBY RD SUBIACO WA 6008
T: (08) 9388 9566 E: mail@plane.com.au